

VS Series – Profile Dimensions

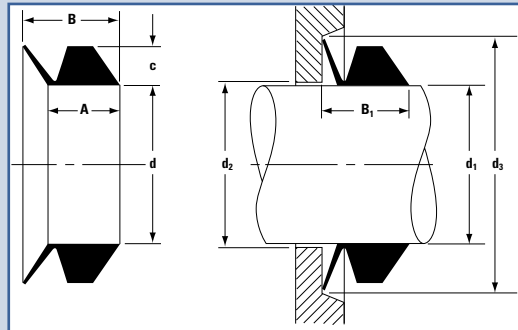

VS Series – Assembly Dimensions

DMR PN	Shaft Dia. d1		I.D. d		Height c		Dim. A		Free Width B		Max. d2 = d1 +		Min. d3 = d1 +		Fitted Width B1	
	mm	Inch	mm	Inch	mm	Inch	mm	Inch	mm	Inch	mm	Inch	mm	Inch	mm	Inch
VS-5	4.6 – 5.3	0.18 – 0.21	4	0.16	2	0.08	3.9	0.15	5.2	0.21	1	0.04	6.3	0.25	4.5 ± 0.4	0.18 ± .016
VS-6	5.3 – 6.6	0.21 – 0.26	5	0.20												
VS-7	6.6 – 7.9	0.26 – 0.31	6	0.24												
VS-8	7.9 – 9.4	0.31 – 0.37	7	0.28												
VS-10	9.4 – 11.4	0.37 – 0.45	9	0.35	3	0.12	5.6	0.22	7.7	0.30	2	0.08	9	0.35	6.7 ± 0.6	0.26 ± .020
VS-12	11.4 – 13.5	0.45 – 0.53	10.5	0.41												
VS-14	13.5 – 15.5	0.53 – 0.61	12.5	0.49												
VS-16	15.5 – 17.5	0.61 – 0.69	14	0.55												
VS-18	17.5 – 19	0.69 – 0.77	16	0.63												
VS-20	19 – 21	0.77 – 0.83	18	0.71												
VS-22	21 – 24	0.83 – 0.95	20	0.79												
VS-25	24 – 27	0.95 – 1.07	22	0.87												
VS-28	27 – 29	1.07 – 1.14	25	0.98	4	0.16	7.9	0.31	10.5	0.41	2	0.08	12	0.45	9.0 ± 0.8	0.35 + .030
VS-30	29 – 31	1.14 – 1.22	27	1.06												
VS-32	31 – 33	1.22 – 1.30	29	1.14												
VS-35	33 – 36	1.30 – 1.42	31	1.22												
VS-38	36 – 38	1.42 – 1.50	34	1.34												
VS-40	38 – 43	1.50 – 1.70	36	1.42												
VS-45	43 – 48	1.70 – 1.89	40	1.57	5	0.20	9.5	0.37	13	0.51	3	0.12	15	0.60	11.0 ± 1.0	0.43 + .040
VS-50	48 – 53	1.89 – 2.09	45	1.77												
VS-55	53 – 58	2.09 – 2.29	49	1.93												
VS-60	58 – 63	2.29 – 2.48	54	2.13												
VS-65	63 – 68	2.48 – 2.68	58	2.28												
VS-70	68 – 73	2.68 – 2.88	63	2.48												
VS-80	78 – 83	3.07 – 3.27	72	2.83	6	0.24	11.3	0.44	15.5	0.61	4	0.16	18	0.70	13.5 ± 1.2	0.53 + .050
VS-85	83 – 88	3.27 – 3.47	76	2.94												
VS-90	88 – 93	3.47 – 3.66	81	3.19												
VS-95	93 – 98	3.66 – 3.86	85	3.35												
VS-100	98 – 105	3.86 – 4.14	90	3.54												
VS-110	105 – 115	4.14 – 4.53	99	3.90												
VS-120	115 – 125	4.53 – 4.92	108	4.25	7	0.28	13.1	0.52	18	0.71	4	0.16	21	0.80	15.5 ± 1.5	0.61 + .060
VS-130	125 – 135	4.92 – 5.32	117	4.61												
VS-140	135 – 145	5.32 – 5.71	126	4.96												
VS-150	145 – 155	5.71 – 6.10	135	5.31												
VS-160	155 – 165	6.10 – 6.50	144	5.67												
VS-170	165 – 175	6.50 – 6.89	153	6.02												
VS-180	175 – 185	6.89 – 7.29	162	6.38	8	0.32	15	0.59	20	0.81	5	0.20	24	0.95	18.0 ± 1.8	0.71 + .070
VS-190	185 – 195	7.29 – 7.68	171	6.73												
VS-199	195 – 210	7.68 – 8.27	180	7.09												