

Back-up rings are washer-like devices that are used to prevent a seal from extruding through any gaps while under pressure. These seals are installed in the downstream side of the gland. Back-up rings are not seals themselves, but are usually used in conjunction with O-rings in high-pressure applications (over 1500 psi) for support or as spacers. Typical applications include hydraulic cylinders and high-pressure hydraulic systems, and high-pressure valves. In many applications it is best to use two back-up rings; one above the o-ring and one below, to provide maximum support.

Back-up rings are available in two distinct face design configurations – a flat, washer style where the ring has two flat, parallel surfaces, much like a washer and a contoured style where one face is straight and the opposite face is curved or contoured. The contoured face is the one that comes in contact with the o-ring, providing better grip and support.

FLAT/WASHER STYLE:

Metric and Standard

Configuration: Solid, Split, Spiral

Materials: PTFE, URETHANE, NYLON

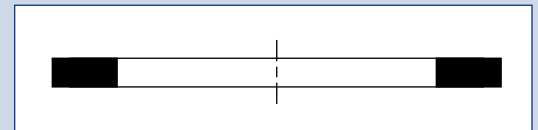

CONTOURED STYLE: (“PARBACK” STYLE):

Material: Nitrile 90 Durometer, Fluoroelastomer 90 Durometer

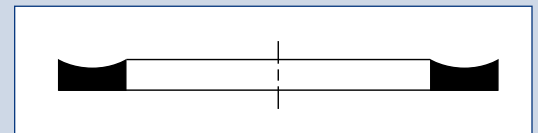

574 STYLE (“STANDARD ONLY”)

Molded of a 90A Durometer Buna-N Rubber. The 574 Style dished

Cross section back-up rings provide excellent extrusion resistance.

Stretched for installation, they return quickly to their original size for easy installation.

PLEASE NOTE: Sizes (Dash NO.) Corresponds to standard o-ring numbers.

Style 574 Buna-N

DMR Part Number	DMR Part Number	DMR Part Number	DMR Part Number	DMR Part Number	DMR Part Number
574-004	574-037	574-121	574-154	574-214	574-247
574-005	574-038	574-122	574-155	574-215	574-248
574-006	574-039	574-123	574-156	574-216	574-249
574-007	574-040	574-124	574-157	574-217	574-250
574-008	574-041	574-125	574-158	574-218	574-251
574-009	574-042	574-126	574-159	574-219	574-252
574-010	574-043	574-127	574-160	574-220	574-253
574-011	574-044	574-128	574-161	574-221	574-254
574-012	574-045	574-129	574-162	574-222	574-255
574-013	574-046	574-130	574-163	574-223	574-256
574-014	574-047	574-131	574-164	574-224	574-257
574-015	574-048	574-132	574-165	574-225	574-258
574-016	574-049	574-133	574-166	574-226	574-259
574-017	574-050	574-134	574-167	574-227	574-260
574-018	574-102	574-135	574-168	574-228	574-261
574-019	574-103	574-136	574-169	574-229	574-262
574-020	574-104	574-137	574-170	574-230	574-263
574-021	574-105	574-138	574-171	574-231	574-264
574-022	574-106	574-139	574-172	574-232	574-265
574-023	574-107	574-140	574-174	574-233	574-266
574-024	574-108	574-141	574-176	574-234	574-267
574-025	574-109	574-142	574-177	574-235	574-268
574-026	574-110	574-143	574-178	574-236	574-269
574-027	574-111	574-144	574-202	574-237	574-270
574-028	574-112	574-145	574-205	574-238	574-271
574-029	574-113	574-146	574-206	574-239	574-272
574-030	574-114	574-147	574-207	574-240	574-273
574-031	574-115	574-148	574-208	574-241	574-274
574-032	574-116	574-149	574-209	574-242	574-275
574-033	574-117	574-150	574-210	574-243	574-276
574-034	574-118	574-151	574-211	574-244	574-277
574-035	574-119	574-152	574-212	574-245	574-278
574-036	574-120	574-153	574-213	574-246	574-279

Style 574 Buna-N

DMR Part Number
574-280
574-281
574-282
574-283
574-284
574-309
574-310
574-311
574-312
574-313
574-314
574-315
574-316
574-317
574-318
574-319
574-320
574-321
574-322
574-323
574-324
574-325
574-326
574-327
574-328
574-329
574-330
574-331
574-332
574-333
574-334
574-335
574-336

DMR Part Number
574-337
574-338
574-339
574-340
574-341
574-342
574-343
574-344
574-345
574-346
574-347
574-348
574-349
574-350
574-351
574-352
574-353
574-354
574-355
574-356
574-357
574-358
574-359
574-360
574-361
574-362
574-363
574-364
574-365
574-366
574-367
574-368
574-369

DMR Part Number
574-370
574-371
574-372
574-373
574-374
574-375
574-377
574-378
574-379
574-380
574-381
574-382
574-383
574-384
574-425
574-426
574-427
574-428
574-429
574-430
574-431
574-432
574-433
574-434
574-435
574-436
574-437
574-438
574-439
574-440
574-441
574-442
574-443

DMR Part Number
574-444
574-445
574-446
574-447
574-448
574-449
574-450
574-451
574-452
574-453
574-454
574-455
574-456
574-457
574-458
574-459
574-460
574-461
574-462
574-463
574-464
574-465
574-466
574-467
574-468
574-469
574-470
574-471
574-472
574-473

Style 575 PTFE

DMR Part Number	DMR Part Number	DMR Part Number	DMR Part Number	DMR Part Number	DMR Part Number
575-004ST	575-031T	575-120T	575-210T	575-230ST	575-260T
575-005ST	575-032T	575-121ST	575-211ST	575-230T	575-261T
575-006ST	575-033ST	575-122ST	575-212ST	575-231T	575-262TS
575-007ST	575-033T	575-122T	575-212T	575-232T	575-263ST
575-008ST	575-034T	575-123ST	575-212TS	575-232TS	575-320T
575-009ST	575-036T	575-124ST	575-212TW	575-232TW	575-325ST
575-010ST	575-037T	575-125ST	575-213ST	575-233T	575-325T
575-010T	575-038ST	575-126ST	575-214ST	575-234T	575-326ST
575-011ST	575-038T	575-127ST	575-214T	575-235ST	575-326T
575-011T	575-039T	575-128ST	575-215ST	575-235T	575-327ST
575-012ST	575-041T	575-129ST	575-216ST	575-236T	575-328ST
575-013ST	575-044T	575-130ST	575-217ST	575-237T	575-329ST
575-014ST	575-045T	575-131ST	575-218ST	575-238T	575-330ST
575-015ST	575-110ST	575-132ST	575-218T	575-239ST	575-330T
575-016ST	575-111ST	575-133ST	575-218TS	575-239T	575-333ST
575-017ST	575-112ST	575-134ST	575-219ST	575-240T	575-333T
575-018ST	575-112T	575-134TS	575-219T	575-240TS	575-334ST
575-019ST	575-112TS	575-135ST	575-220ST	575-241ST	575-334TS
575-020ST	575-113ST	575-136ST	575-220T	575-242T	575-335T
575-020T	575-114ST	575-137ST	575-220TS	575-243ST	575-336ST
575-021ST	575-114T	575-138ST	575-221ST	575-244T	575-338ST
575-022ST	575-115ST	575-139T	575-221T	575-244T	575-338T
575-022T	575-116ST	575-139TS	575-222ST	575-245T	575-340ST
575-023ST	575-116T	575-140T	575-223T	575-247T	575-340TS
575-024ST	575-116TS	575-140TS	575-223TS	575-248T	575-341ST
575-025ST	575-117ST	575-141T	575-224ST	575-249ST	575-342ST
575-026ST	575-117T	575-144ST	575-224T	575-249T	575-344ST
575-026T	575-118ST	575-146T	575-225ST	575-250T	575-345ST
575-027ST	575-118T	575-148T	575-226ST	575-252T	575-346ST
575-028ST	575-118TS	575-149T	575-226TS	575-253T	575-349T
575-029ST	575-119ST	575-152T	575-227ST	575-254T	575-349TS
575-029T	575-119T	575-159T	575-228ST	575-256T	575-350ST
575-030ST	575-120ST	575-210ST	575-229ST	575-258T	575-354ST

ST= split T= Solid TS=Spiral Cut TW= .085 wide

Style 575 PTFE

DMR Part Number
575-356ST
575-359T
575-360T
575-362ST
575-363T
575-364T
575-365T
575-367ST
575-375T
575-379T
575-413ST
575-425ST
575-426ST
575-427ST
575-430ST
575-431T
575-433ST
575-436ST
575-437T
575-438T
575-439T
575-440ST
575-443T
575-445TS
575-446T
575-447T
575-448T
575-450T
575-451T
575-452T
575-454T

ST= split T= Solid TS=Spiral Cut TW= .085 wide

Style 575 URETHANE

DMR Part Number
575-004
575-005
575-006
575-007
575-008
575-009
575-010
575-011
575-012
575-013
575-014
575-015
575-016
575-017
575-018
575-019
575-020
575-021
575-022
575-023
575-024
575-025
575-026
575-027
575-028
575-029
575-030
575-031
575-032
575-033
575-034
575-035
575-036

DMR Part Number
575-037
575-038
575-039
575-040
575-041
575-042
575-043
575-044
575-045
575-046
575-047
575-048
575-049
575-050
575-102
575-103
575-104
575-105
575-106
575-107
575-108
575-109
575-110
575-111
575-112
575-113
575-114
575-115
575-116
575-117
575-118
575-119
575-120

DMR Part Number
575-121
575-122
575-123
575-124
575-125
575-126
575-127
575-128
575-129
575-130
575-131
575-132
575-133
575-134
575-135
575-136
575-137
575-138
575-139
575-140
575-141
575-142
575-143
575-144
575-145
575-146
575-147
575-148
575-149
575-150
575-151
575-152
575-153

DMR Part Number
575-154
575-155
575-156
575-157
575-158
575-159
575-160
575-160
575-161
575-162
575-163
575-164
575-165
575-166
575-167
575-168
575-169
575-170
575-171
575-172
575-173
575-174
575-175
575-205
575-206
575-207
575-208
575-209
575-210
575-211
575-212
575-213
575-214

DMR Part Number
575-215
575-216
575-217
575-218
575-219
575-220
575-221
575-222
575-223
575-224
575-225
575-226
575-227
575-228
575-229
575-230
575-231
575-232
575-233
575-234
575-235
575-236
575-237
575-238
575-239
575-240
575-241
575-242
575-243
575-244
575-245
575-246
575-247

DMR Part Number
575-248
575-249
575-250
575-251
575-252
575-253
575-254
575-255
575-256
575-257
575-258
575-259
575-260
575-261
575-262
575-263
575-264
575-265
575-266
575-267
575-268
575-269
575-270
575-271
575-272
575-273
575-274
575-275
575-276
575-278
575-279
575-309
575-310

Style 575 URETHANE

DMR Part Number
575-311
575-312
575-313
575-314
575-315
575-316
575-317
575-318
575-319
575-320
575-321
575-322
575-323
575-324
575-325
575-326
575-327
575-328
575-329
575-330
575-331
575-332
575-333
575-334
575-335
575-336
575-337
575-338
575-339
575-340
575-341
575-342
575-343

DMR Part Number
575-344
575-345
575-346
575-347
575-348
575-349
575-350
575-351
575-352
575-353
575-354
575-355
575-356
575-357
575-358
575-359
575-360
575-361
575-362
575-363
575-364
575-365
575-366
575-367
575-368
575-369
575-370
575-371
575-372
575-373
575-374
575-375
575-376

DMR Part Number
575-377
575-379
575-381
575-382
575-383
575-421
575-425
575-426
575-427
575-428
575-429
575-430
575-431
575-432
575-433
575-434
575-435
575-436
575-437
575-438
575-439
575-440
575-441
575-442
575-443
575-444
575-445
575-446
575-447
575-448
575-448
575-449
575-450

DMR Part Number
575-451
575-452
575-453
575-454
575-455
575-456
575-457
575-460

Style 576 NYLON

DMR Part Number	ID	OD	HT
576-314	3/4	1-1/8	.070
576-216	1-1/8	1-3/8	.060
576-320	1-1/8	1-1/2	.070
576-324	1-3/8	1-3/4	.070
576-325	1-1/2	1-7/8	.070
576-326	1-5/8	2	.070
576-327	1-3/4	2-1/8	.070
576-328	1-7/8	2-1/4	.070
576-329	2	2-3/8	.070
576-330	2-1/8	2-1/2	.070
576-331	2-1/4	2-5/8	.070
576-407	2-1/4	2-3/4	.070
576-2.37X.125	2-3/8	2-5/8	.070
576-332	2-3/8	2-3/4	.060
576-408	2-3/8	2-7/8	.070
576-2.50X.125	2-1/2	2-3/4	.070
576-333	2-1/2	2-7/8	.070
576-409	2-1/2	3	.070
576-334	2-5/8	3	.070
576-2.62X3.00X.085	2-5/8	3	.085
576-2.62X3.12X.06	2-5/8	3-1/8	.060
576-411	2-3/4	3-1/4	.070
Part Number	ID	OD	HT
576-412	2-7/8	3-3/8	.070
576-413	3	3-1/2	.070
576-338	3-1/8	3-1/2	.070
576-3.18X3.75	3-3/16	3-3/4	.070
576-415	3-1/4	3-3/4	.070
576-3.4X4.0X1/8	3.405	4	.125
576-417	3-1/2	4	.070
576-418-1/2	3-11/16	4-3/16	.070
576-419	3-3/4	4-1/4	.070
576-421	4	4-1/2	.070
576-4X5	4	5	.125

DMR Part Number	ID	OD	HT
576-423-1	4-1/4	4-3/4	.070
576-425	4-1/2	5	.070
576-4.5X5.2	4-1/2	5-1/4	.130
576-427	4-3/4	5-1/4	.070
576-429	5	5-1/2	.075
576-433	5-1/2	6	.120
576-5.5X6.25	5-1/2	6-1/4	.187
576-5.75X.185	5-3/4	6-1/8	.185
576-6.00X6.75X.125	6	6-3/4	.125
576-6X7	6	7	.125